

### Features

- Cavity Duplexer for LTE Band 3.
- Very compact size and low weight. ( 100 x 100 x 30 mm)
- 1.5 dB typical Insertion loss @ room temp.
- 85 dB typical DL to UL Isolation.



### Electrical Specifications

#### Duplexer DL Path (DL → ANT)

PARAMETER	SPECIFICATION	COMMENT
Frequency Range	1,805 MHz ~ 1,880 MHz	BW = 75 MHz
Insertion Loss	1.8 dB Max.	Over whole temp. range
Pass Band Ripple	1.0 dB Max.	
Return Loss	18.0 dB Min.	
Isolation	80.0 dB Min.	@1,710 MHz ~ 1,780 MHz
Max Power	100 Watts	CW
Impedance	50 Ω	

#### Duplexer UL Path (ANT → UL)

PARAMETER	SPECIFICATION	COMMENT
Frequency Range	1,710 MHz ~ 1,780 MHz	BW = 75 MHz
Insertion Loss	1.8dB Max.	Over whole temp. range
Pass Band Ripple	1.0 dB Max.	
Return Loss	18.0 dB Min.	
Isolation	80.0 dB Min.	@1,805 MHz ~ 1,880 MHz
Impedance	50 Ω	

### Environmental

Operating temperature range      -20 to +70 °C

### Mechanical

Dimensions<sup>1)</sup>                              100 x 100 x 30 mm

1) Excluding connectors, and mounting bracket extension

# Outline Drawing

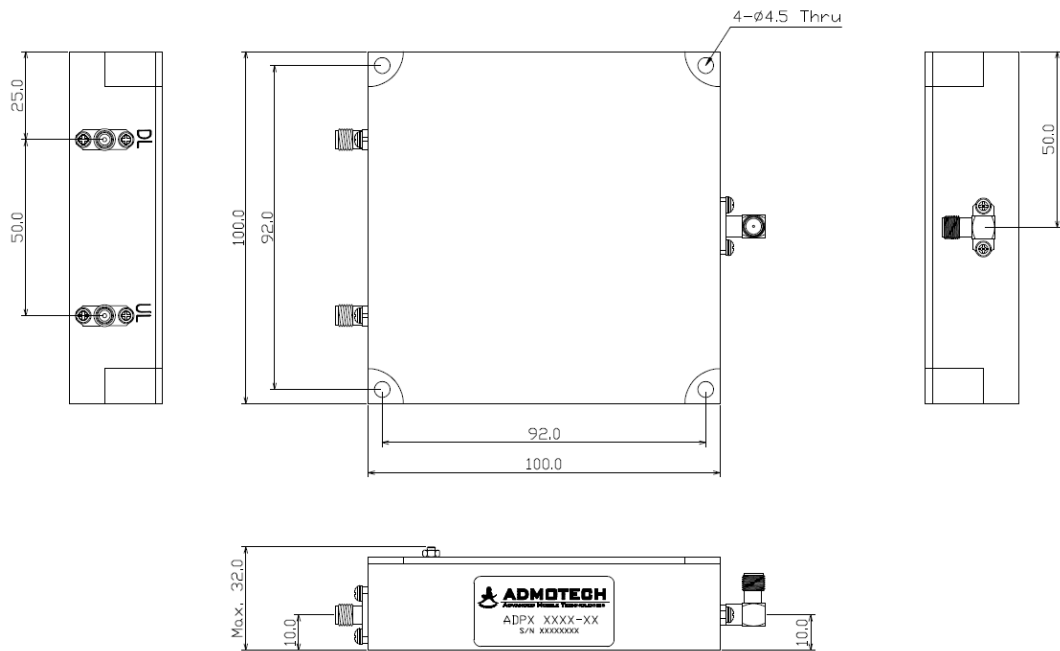

Units : mm, Tolerance : +/- 0.2 mm

# Typical Response



Duplexer DL path Transmission

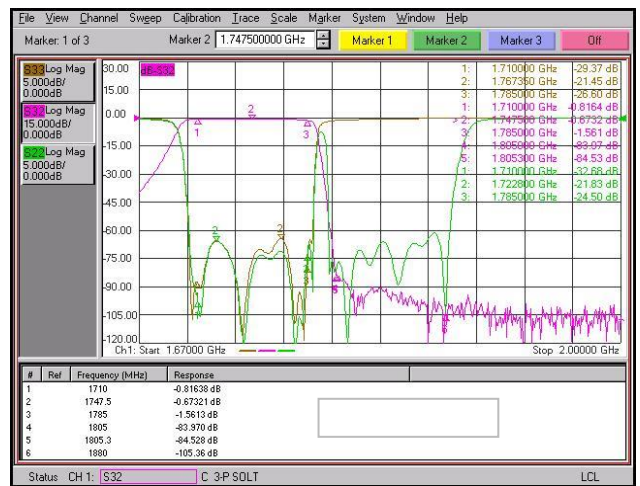

Duplexer UL path Transmission