

Project Name	Unit Band Pass Filter	Part No. ADBF 670/25-SCM	Revision 1.0	Page 1 of 3
--------------	--------------------------	-----------------------------	-----------------	----------------

Electrical Specifications for Band Pass Filter

ADBF 670/25-SCM



ADMOTECH

2020. 1. 21.



1. Specifications

Parameter	Specification	Remark
Frequency Range	657.5 MHz ~ 682.5 MHz	BW = 25 MHz
Center Frequency	670 MHz	
Insertion Loss @ Center Frequency	3.5 dB Max.	
Pass Band Ripple	0.5 dB Max.	
Return Loss	15.0 dB Min.	
Attenuation	48 dB Min. @ DC ~ 615 MHz 50 dB Min. @ 725 ~ 2,000 MHz	
Max Power	CW 1 Watts	
Impedance	50 Ω	
Operating Temperature	-40 °C ~ +85 °C	

2. Outline Drawing

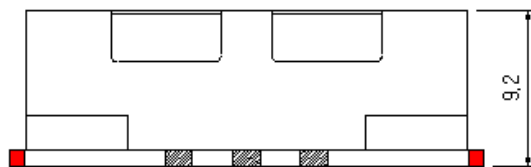
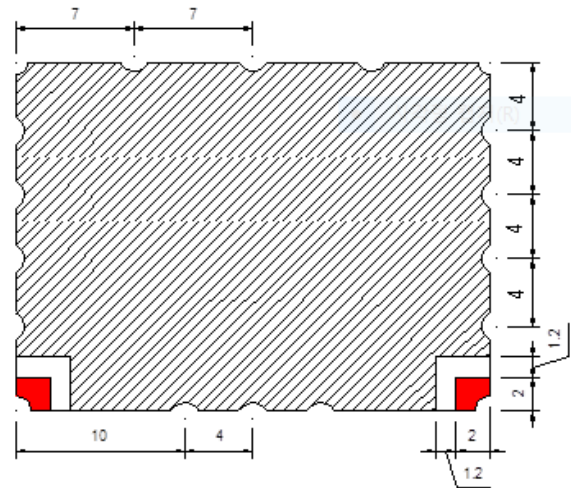
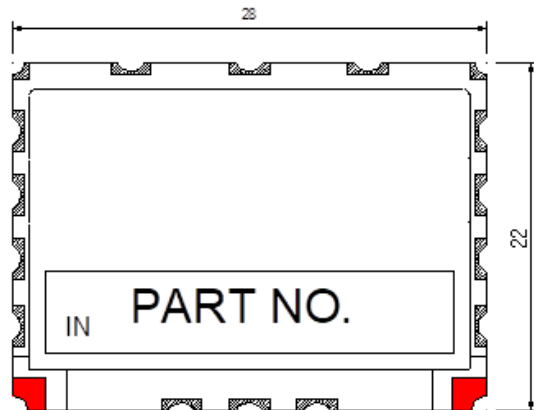

OTHERWISE SPECIFIED : ±0.3
 DIMENSIONS : mm

 : I/O PORT
 : GROUND

Project Name	Unit	Part No.	Revision	Page
	Band Pass Filter	ADBF 670/25-SCM	1.0	3 of 3

3. Tested Plot

